

Making Aboriginal Cultural Connections Happen



Melton Botanic Garden

Growing Plants Growing People



Overview

- Background
- Video
- Gardens & Plants
- Questions



**FMBG Patron
Jane Edmanson**



FMBG Strategic Plan



- Objectives
 - To promote Cultural and Heritage principles and recognise the contribution of the Traditional Owners
- Actions

5.2 Foster relationships and involvement with cultural and heritage groups and other groups which are compatible with the spirit of the botanic garden development.	Develop areas of the garden as per the Plan with the involvement of cultural and heritage groups and other groups as appropriate.
--	---

A map of Victoria, Australia, highlighting the four main Aboriginal language groups in red boxes: Dja Dja Wurrung (top left), Taungurung (top right), Wurundjeri (center left), and Wathaurung (bottom left). The map shows major cities, rivers, and geographical features. The Dja Dja Wurrung group is located in the north-west, Taungurung in the north-east, Wurundjeri in the central-west, and Wathaurung in the south-west. Melbourne is marked as the center of the Wurundjeri group. Other groups shown include Wimmeri, Wotjadjari, and Watharrpi.

Map: 25 August 2017



Traditional Owners of Melton
Kurung-jang Bulluk ~
Red Earth People
of the Woi~Wurrung Nation

ABORIGINAL HEALTH STRATEGY

ABORIGINAL LIAISON OFFICER – DAMIEN LOIZOU



Oct 2014



A Safe Community Place

- involves, supports and encourages Aboriginal peoples participation
 - a Greek or Chinese Hall maybe viewed by the respective communities as a safe place for Greek or Chinese people to openly celebrate customs and do so in a supportive environment
- focal point being to acknowledge and respect Aboriginal culture, custom and history
- a place in which the Aboriginal community connects to celebrate custom history and culture

Cultural Safe Space

- Connecting people to Country, land, waterways, cultural traditions and community ...
- Ceremonial circle connects people to country and community culture through delivery and bare feet, pounding of the ground connects to ancestral storylines and dreaming etc...
- Reclaiming plant knowledge and use
 - significant element to cultural practice

Making it Happen

- Welcoming
- Respecting
- Understanding
- Sharing
- Engaging
- Supporting
- Working through Situations
- Allowing time (Patience)

Major Players

- FMBG
- Djerriwarrh Health Services
 - Melton Men's Aboriginal Group
 - Aboriginal Parent's Group
- Melton City Council
- Department of Education

Timeline

- First approach to FMBG 2014
- Introductions
- Meetings
- Project Proposal
- Community Partnership Sept 2015
- Ceremonial Circle Brief
- Wurundjeri Council





January 2017



OUR COMMUNITY -it's a Partnership!



Community Partnerships

- The Community Partnership Program is for community organisations from different cultural, religious and linguistic backgrounds to come together and work in partnership on a joint project
- The program links community groups with each other, to work in partnership to produce projects to their own benefit and that of the wider community
- Sharing of skills, experience and knowledge with others so we can grow together

Video – 4 minutes

- Joanne - Woiwurrung
- Damien – Warlpiri
- Andrew – Gunditjamara
- Aboriginal and Torres Strait Islander Community
- <https://youtube/Y1h-qgrvxjl>

Plants & Gardens

- Boomerang Garden
- Bushfoods Garden
- Koori Student Garden
- Indigenous Peoples Garden
- Indigenous plantings
 - Ryans Creek
 - around the Lake
 - Remnant vegetation

Indigenous People's and Bushfoods Gardens





Mural

Boomerang Garden

Ceremonial Circle

3 August 2017

Ceremonial Circle



NAIDOC 2017







Mural plans

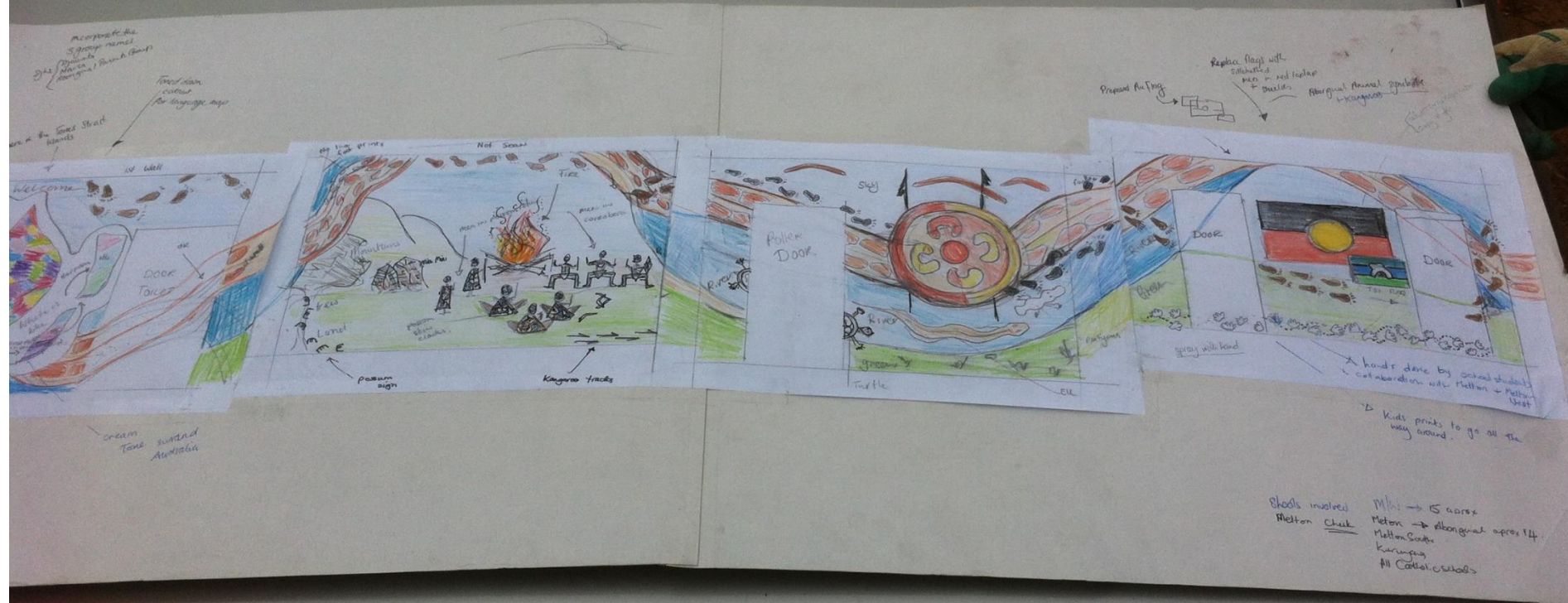





Proposed Au Flag

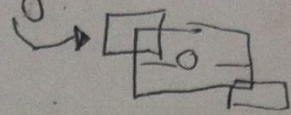

men in red
+ shields

Aboriginal Animal
+ Kangaroo

Aboriginal symbols
copy right

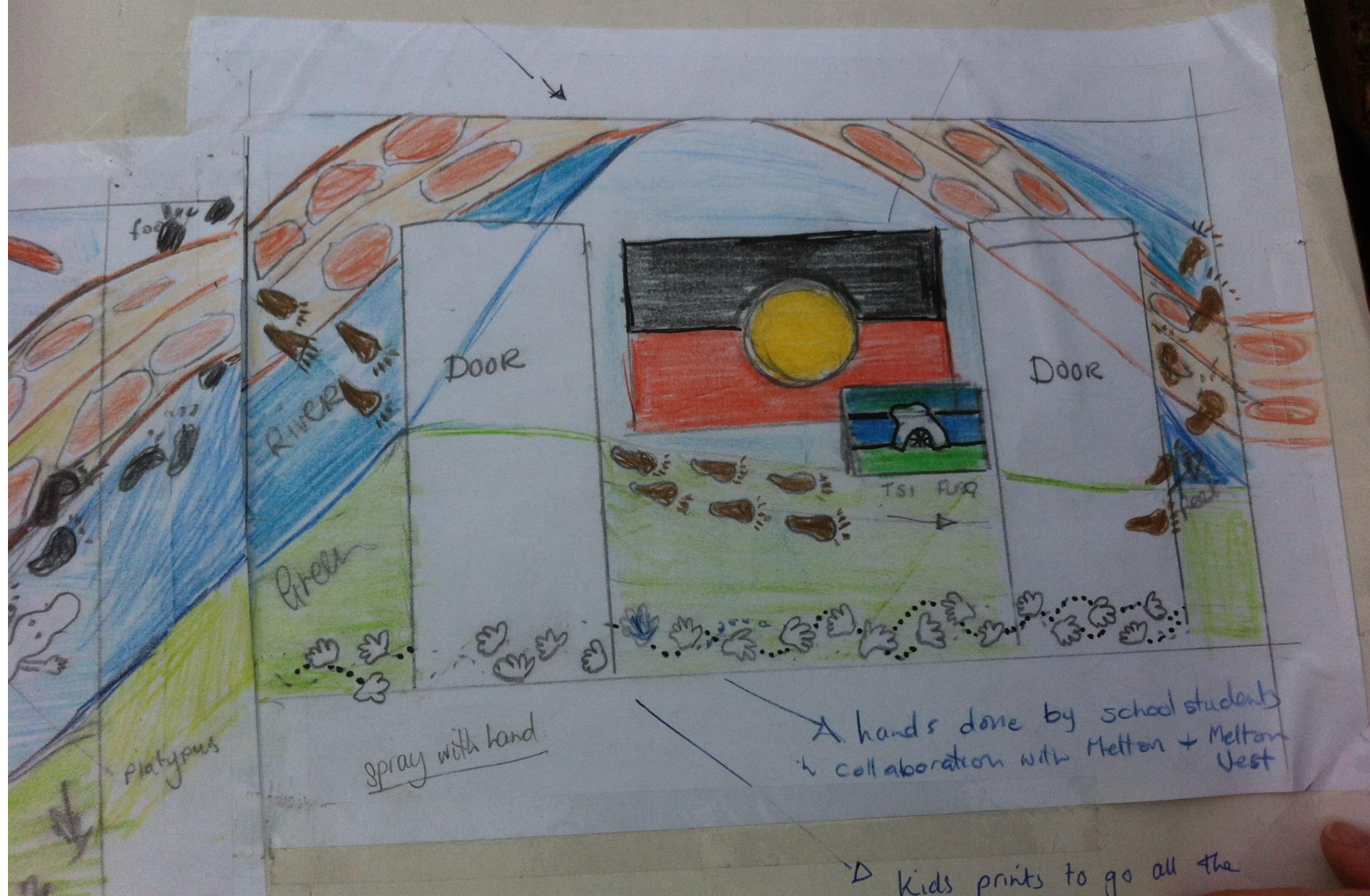

spray with hand

A hands done by school students
in collaboration with Melton + Melton
Vest

△ Kids prints to go all the







Wominjeka ~ Welcome

A large mural of Australia is painted on a light blue wall. The map of Australia is filled with numerous small, colorful regions, each labeled with an indigenous name in black text. The names are written in various colors to match the background of the regions. The map is surrounded by a white border. To the right of the map, a person is painting the wall. The person is wearing a black jacket and is using a brush to paint a white line. There are paint containers and brushes on a table in the foreground. The wall is part of a building with a corrugated metal roof. A door with a wheelchair symbol is visible on the right side of the wall. The text "Wominjeka ~ Welcome" is painted in black at the top of the wall.









Gardens and Plants

- create a sense of connection through the plant collections
 - medicinal, ceremonial, food source plants and other plant uses which had been lost for decades through the colonization process of this Country.
- fundamental to create meaningful connections for our First Nation people
 - to build the bridge to reconciliation



NAIDOC 2017

Koori Student Garden



SUGGESTED INDIGENOUS PLANTINGS

Trees

Acacia implexa
Acacia pycnantha
Allocasuarina littoralis
Banksia marginata
Bursaria spinosa

Shrubs

Grevillea rosmarinifolia
Correa glabra
Indigofera australis
Senna artemisioides ssp. filifolia
Viminaria juncea

Ground Covers and grasses

Brachyscome multifida
Calocephalus citreus
Dianella longifolia
Eryngium ovium
Kennedia prostrata
Lomandra filiformis
Myoporum parvifolium
Pelargonium rodneanum
Poa labillardieri
Ptilotus macrocephalus
Xerochrysum viscosum

ABORIGINAL SYMBOLISM

- Organic, features in the landscape representing the natural landscape and suggesting movement.
- Use of red, orange and yellow ochre colours in the landscape representing the art and culture of local people.
- Use of local indigenous plants that has traditional applications and are important for local fauna including birds and butterflies.

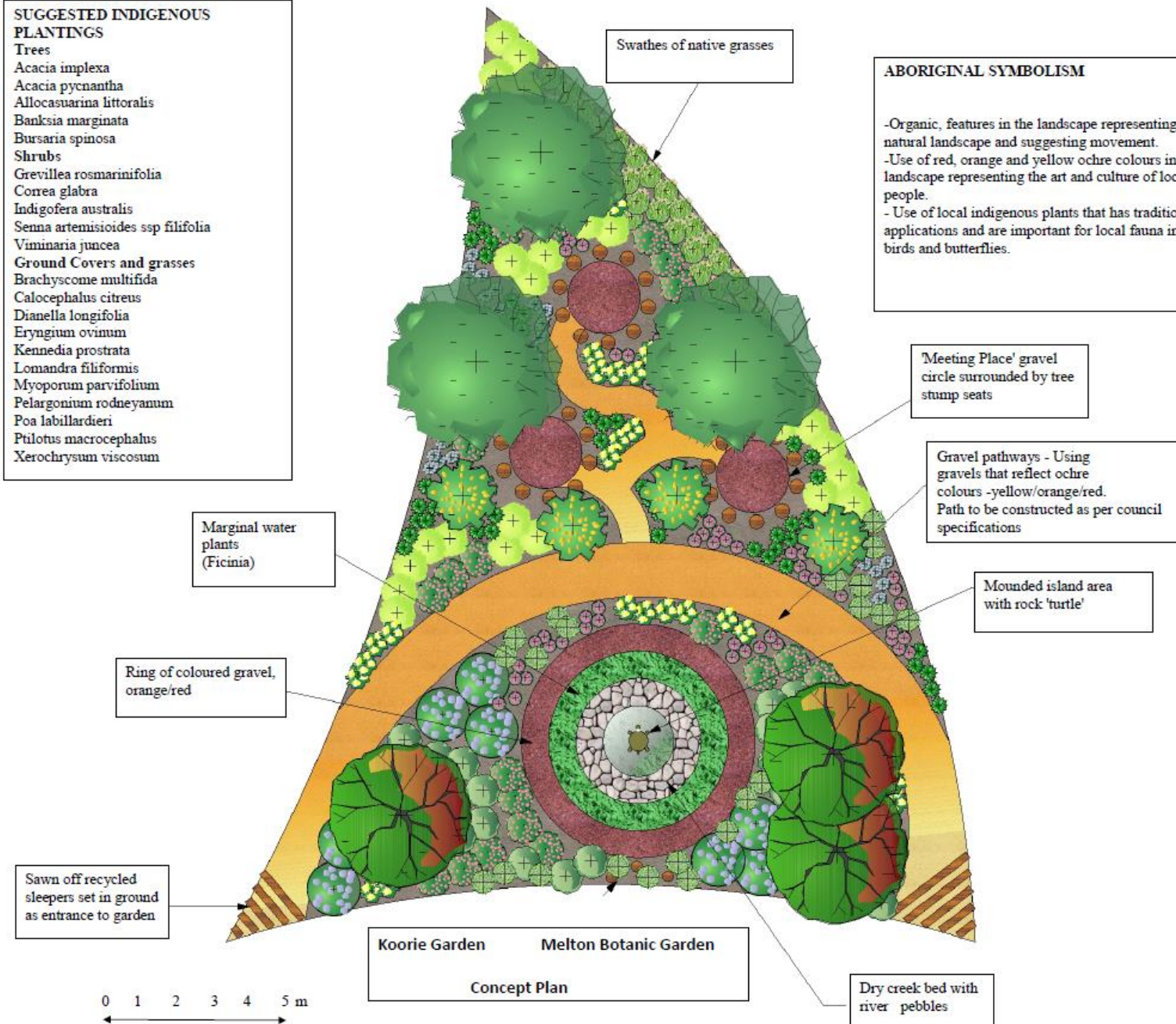

Koorie Student Garden







Victorian Volcanic Plains Aboriginal Plant Usage Garden

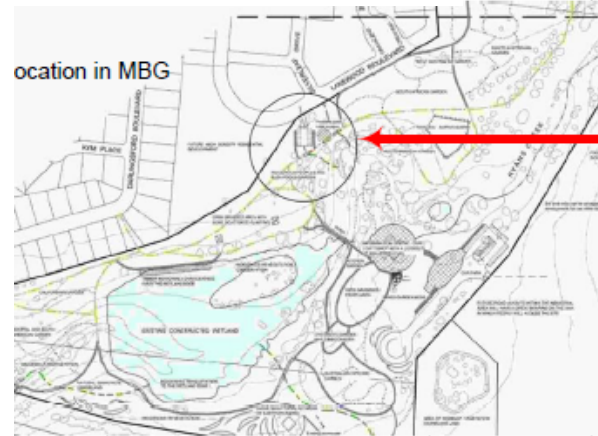

Funding

Lions
Western Water
FMBG
CVGT

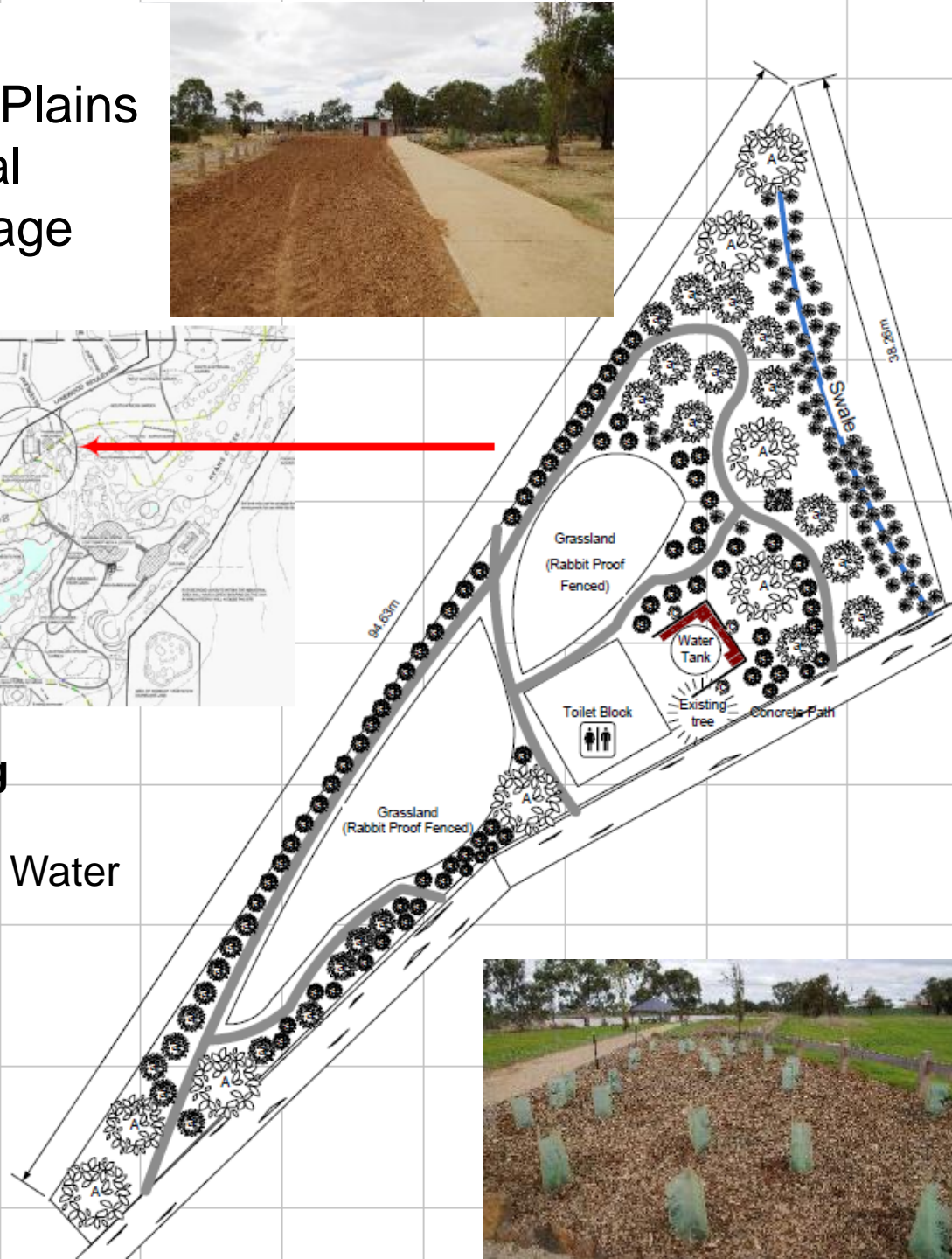



Victorian Volcanic Plains Grasslands
Microseris lanceolata, Yam Daisy, Murrnong (Koorie name)



Spring 2016



Indigenous Peoples Garden Dec 2016



June 2017



May 2016

Bushfoods Garden



Nov 2016



Bushfoods Garden



Native Elderberry
Sambucus gaudichaudiana



May 2017



Bushfood signage

Ongoing Engagement



Events

Aboriginal Children events
Aboriginal Community events
Summer Solstice Celebration
Launch events



Join the Friends of the Melton Botanic Garden and the Melton Aboriginal Men's Group as they showcase their mural and ceremonial circle.

These projects connect Aboriginal culture, history and community through artwork, indigenous plantings and the creation of a ceremonial circle.

Come along, learn more from the participating groups, join in for a demonstration and enjoy morning tea in the garden.

BOOK EARLY! Don't miss out!

EVENT DETAILS:

WHEN:
Thursday 2 June
TIME:
10am - 11am

WHERE:
Melton Botanic Garden Car Park
Lakewood Boulevard, Melton

COST:
FREE

RSVP:
Friday 27 May 2016
Simone Gordon
P: 9747 7200
E: admin@melton.vic.gov.au

Please advise of any dietary requirements
For more information, visit
melton.vic.gov.au



MELTON COMMUNITY BBQ

Western VACCA (based in Werribee) is holding a Community BBQ for Aboriginal Children and their families at the Melton Botanic Gardens.

Please come and meet the Western VACCA staff and each other on

TIME: 2.30 PM
WHERE: 21 Williams St, Melton (Lakewood Boulevard entrance)
WHEN: Thursday 24th March at 2.30pm at

There will be Cultural dancers, Music and Art Activities for the Children.

For enquiries please contact Jarara or Kiyah at the Western VACCA office on 9742 8300

VACCA
Connected by culture

NAIDOC 2017

Wominjeka - Welcome

WHERE: Melton Botanic Gardens
DATE: Sunday 2nd July 2017 **TIME:** 11.30am - 2.30pm

Lunch provided, live music, face painting, jumping castle, dancers, boomerang throwing and painting, Family Photo

FREE

Tullidge st
Lakewood Blvd
Darlingsford Blvd
Lakewood Blvd
Car Park
NAIDOC Community BBQ

djerriwarrh health services
Southwest • Melton • Caroline Springs



FMBG Guided Tours



Reconciliation Week Tour



Bushfoods Morning Tea



BGANZ Open Day





Spirit Creator

3 August 2017

Rock Artwork



Outcomes

- Cultural safe space
- Ceremonial Circle
- Language map and mural
- Indigenous Peoples themed gardens
- Community events
- Involvement in activities
- Learning respect for each other
- Connection to country

Thankyou and Questions

